

Delux 360° Service

Technical details

- Led's luminaire 845mm high, complete with base for plinth/floor installation
- Energy and service distribution bollard, for the mains connection of portable appliances, gardens tools, phones, etc.... Possible options: emergency light, USB port, motion sensor
- Preset for installation on a Ø60mm pole
- Polyester powder coating after specific weathering resistance treatment
- Silicone gaskets
- Anodized aluminium heat sink
- PG9 metallic cable gland complete with osmotic valve for leakage of air and humidity
- N°24 LED's and PCB in IMS
- LED's circuit mains powered
- A2 stainless steel screws

Top cover

- Anodised and painted die-cast aluminium top cover

Diffuser

- Non yellowing transparent PMMA (acrylic) diffuser

Housing

- Anodised and painted extruded aluminium housing

Base

- Reinforced thermoplastic base for plinth/floor installation, or for installation on a Ø60mm pole

Modules

- Preset for 2 modules
- IP55 waterproof panel (with front cover closed)
- SCHUKO power socket - 2 modules (1 panel)
- Removable torch - 2 modules (1 panel)
- USB port - 1 module (half a panel)
- Motion sensor - 1 module (half a panel)
- Blanking module - 1 module (half a panel)
- 1P 10A way switch - 1 module (half a panel)

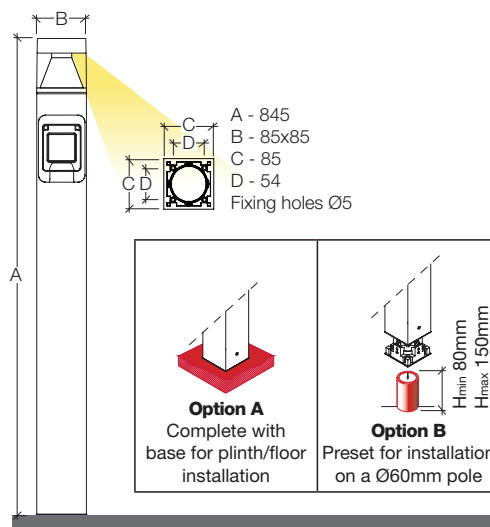

I = Pole spacing (m)

Emed = Average illuminance (Lux)

Emin = Minimum illuminance (Lux)

	I m	Emed Lux	Emin Lux
10W	4	20	5

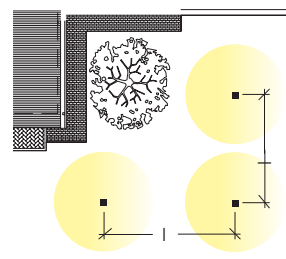

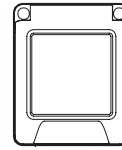

Pay attention:
**Modules are not installed
by Mareco Luce**

- IP55 waterproof panel, 2 modules, Eikon, Arké and Plana Vimar®/Perry® series



Universal SCHUKO socket - 2 modules (1 panel)

- Socket 2P+T 16A 250V~universal, for europlugs 2P 2,5A
- Socket 2P and 2P+T 10A and 16A Italian standard
- Socket 2P+T 16A German standard
- It does not make the earth connection with the socket 2P+T 16A 250V~ French standard



Blanking module - 1 module (half a panel)

- Blanking module



Removable torch - 2 modules (1 panel)

- LED 0,5W 20Lm, it switches on when the power supply fails
- IP20, Class 2
- Removable and complete with on-off switch
- Equipped with anti-theft screw



USB port - 1 module (half a panel)

- Power supply unit 5V 1.5A for electronic devices
- 1 USB output, type A
- Power supply 120-230V~ 50/60Hz



Motion sensor - 1 module (half a panel)

- Switch with infrared motion sensor for turning on the lights, twilight sensor threshold regulation, and cycle timing control
- Relè output NO 6A 230V~
- Power supply 230V~ 50-60Hz



Switch - 1 module (half a panel)

- 1P 10 AX 250V~1-way switch, lightable, replaceable button
- Max 100W for self-ballasted lamps

K/Power Code

4000K - 10W	1021.S82S	1
3000K - 10W	1021.S84S	1

Modules Code

SCHUKO power socket	1025.0001	1
Blanking module	1025.0002	1
Removable torch	1025.0003	1
USB port	1025.0004	1
Motion sensor	1025.0005	1
1P 10A way switch	1025.0006	1

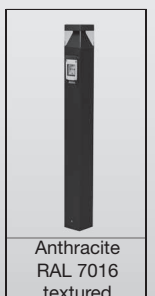

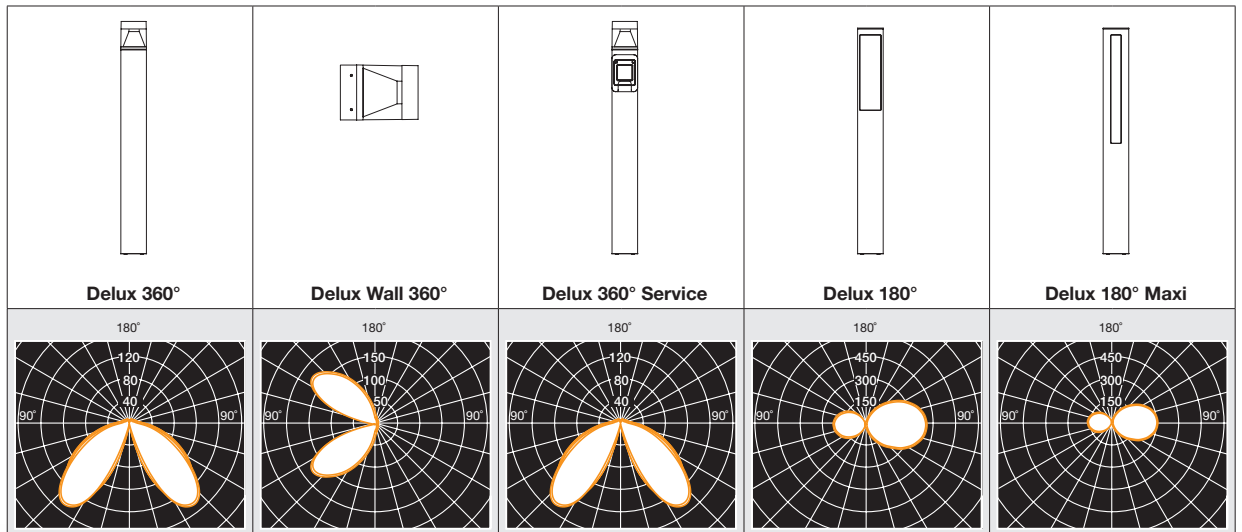

Wall installation		--		--	--	--	--	--	--	--	
Ground installation			--								
Complying ECC standards											
Insulation class											
Voltage		220-240V 50/60Hz		220-240V 50/60Hz		220-240V 50/60Hz		220-240V 50/60Hz		220-240V 50/60Hz	
Step MacAdam		3		3		3		3		3	
Life time		L70/B50>54Kh-Tc 105°C		L70/B50>54Kh-Tc 105°C		L70/B50>60Kh-Tc 105°C		L70/B50>60Kh-Tc 105°C		L70/B50>60Kh-Tc 105°C	
Colour temperature		3000K	4000K	3000K	4000K	3000K	4000K	3000K	4000K	3000K	4000K
Luminaire output		10W 663 lm	10W 663 lm	10W 663 lm	10W 663 lm	10W 663 lm	10W 663 lm	10W 869 lm	10W 869 lm	10W 710 lm	10W 710 lm
IP (Protection degree)		IP65		IP65		IP55		IP65		IP65	
IK (Impact resistance)		IK04		IK04		IK04		IK06		IK06	
Year warranty											
Photobiological risk											
Pre-wired with:		15cm cable H05RN-F 3x0,75mm ²		90cm cable H05RN-F 3x0,75mm ²		15cm cable H05RN-F 3x0,75mm ²		25cm cable H05RN-F 2x0,75mm ²		25cm cable H05RN-F 2x0,75mm ²	
CRI		≥80		≥80		≥80		≥80		≥80	
Connector IP68 CS093000 (linear) and CS093001 ("T"-3 ways) not included											
		The "T"-3 ways and linear IP68 connector can be placed inside the luminaire		The "T"-3 ways and linear IP68 connector cannot be placed inside the luminaire		The "T"-3 ways and linear IP68 connector can be placed inside the luminaire		The "T"-3 ways and linear IP68 connector can be placed inside the luminaire		The "T"-3 ways and linear IP68 connector can be placed inside the luminaire	



Technical details

							
Delux 90°		Delux Indi		Delux Service		Delux Round	
							
--		--		--		--	
✓		✓		✓		✓	
✓		✓		✓		✓	
				--			
220-240V 50/60Hz		220-240V 50/60Hz		--		220-240V 50/60Hz	
3		3		--		3	
L70/B50>60Kh - Tc 105°C		L90/B50>50Kh - Tc 105°C		--		L70/B50>54Kh - Tc 105°C	
 3000K	 4000K	 3000K	 4000K	--		 3000K	 4000K
15W 969 lm	15W 969 lm	8,4W 572 lm	8,4W 589 lm	--		10W 663 lm	10W 663 lm
IP65		IP65		IP55		IP65	
IK03		IK06		--		IK04	
✓		✓		✓		✓	
✓		✓		--		✓	
25cm cable H05RN-F 3x0,75mm ²		25cm cable H05RN-F 2x0,75mm ²		--		15cm cable H05RN-F 3x0,75mm ²	
≥80		≥80		--		≥80	
							
The "T"-3 ways and linear IP68 connector can be placed inside the luminaire		The "T"-3 ways and linear IP68 connector can be placed inside the luminaire		The "T"-3 ways and linear IP68 connector can be placed inside the luminaire		The "T"-3 ways and linear IP68 connector can be placed inside the luminaire	