

Toce

Buried pole - System A

- Cylindrical pole Ø60x3000mm for ground fixing made of hot-dip galvanised steel 75µm UNI EN 1461

Flanged pole - System B

- Cylindrical pole Ø60x3000mm for plinth/floor fixing complete with flange made of hot-dip galvanised steel 75µm UNI EN 1461
 - 200x200mm flange, 8mm thick made of hot-dip galvanised steel 75µm UNI EN 1461

Technical details

- Polyester powder coating after a treatment specific for weathering resistance
 - A2 stainless steel screws

Compulsory accessory (to be ordered separately)

- Counter flange 200x200x3mm and anchor bolts kit M14x330mm (only system B)

Buried pole - System A

Total height	Total ground height	Anthracite RAL 7016 textured	
3000mm	2500mm	1410.100S	1

Flanged pole - System B

3000mm	3000mm	1411.100S	1
--------	--------	-----------	---

Compulsory accessory system B

	Code		
Counter flange and anchor bolts kit	4000.0001	1	

Suggested plinth 600x600x700mm
 Pole conforming to DIN norms

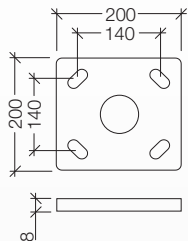

Flange for floor installation
 Fixing holes Ø16mm

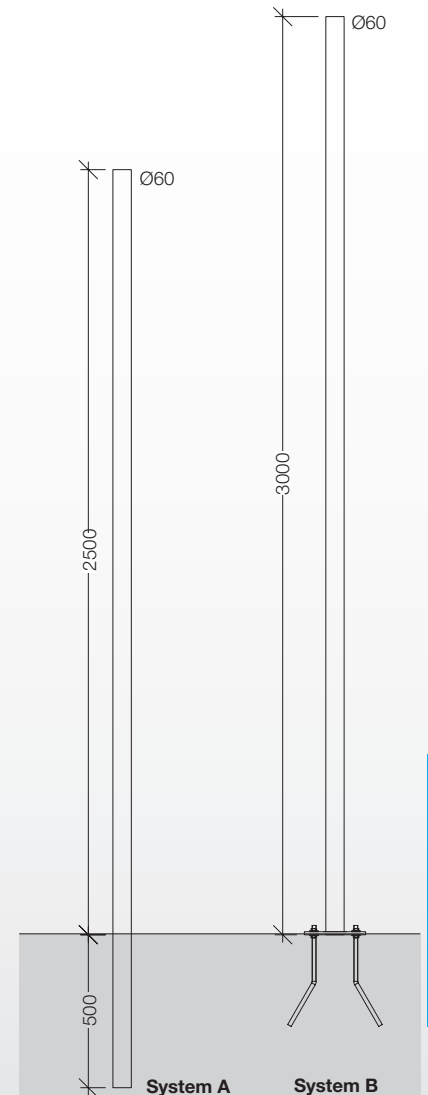

Luminaire/Poles									
	Full Black	Full Color	Rigo	Toce	Piave	Stud System	Stud Solar System	Oracolo Wall System	New Stelo TP Wall System
Edge Head-pole	--	--	--	--	✓	--	--	--	--
Challenge Basic Head-pole	--	--	--	--	✓	--	--	--	--
Discovery Head-pole	--	--	--	--	✓	--	--	--	--
Discovery Side entry	--	--	--	--	✓	--	--	--	--
Cd Led	--	--	--	✓	✓	--	--	--	--
Stud Led	--	--	--	--	--	✓	--	--	--
Stud Solar	--	--	--	--	--	--	✓	--	--
Oracolo	--	--	--	--	✓	--	--	✓	--
Indus	--	--	--	--	✓	--	--	--	--
Skill	--	--	--	--	✓	--	--	--	--
Barcellona & Barrio Range	--	--	--	✓	✓	--	--	--	--
Easy Lux TP	✓	--	✓	--	--	--	--	--	--
Coled TP	✓	✓	--	--	--	--	--	--	--
New Stelo TP Range	✓	--	✓	--	--	--	--	--	✓
Antera	✓	✓	--	--	--	--	--	--	--
Versus	✓	✓	✓	--	--	--	--	--	--
Luna	--	✓	--	--	--	--	--	--	--
Luna TP	✓	✓	✓	--	--	--	--	--	--
Chone Solar	✓	✓	✓	--	--	--	--	--	--
Sfera Led Ø250/300	✓	--	✓	--	--	--	--	--	--
Sfera Led Ø400	--	--	--	✓	--	--	--	--	--
Sfera Led Ø500	--	--	--	✓	--	--	--	--	--
Sfera 1080	✓	--	✓	--	--	--	--	--	--
Sfera Ø400	--	--	--	✓	--	--	--	--	--
Sfera Ø500	--	--	--	✓	--	--	--	--	--
Sfera Ø600	--	--	--	✓	--	--	--	--	--

Technical details