

# Stud System

## Buried pole - System A

- Cylindrical pole Ø102/60x4500mm for ground fixing made of hot-dip galvanised steel 75µm UNI EN 1461

## Flanged pole - System B

- Cylindrical pole Ø102/60x4000mm for plinth/floor fixing complete with flange made of hot-dip galvanised steel 75µm UNI EN 1461  
 - 250x250mm flange, 10mm thick made of hot-dip galvanised steel 75µm UNI EN 1461  
 - Painted thermoplastic flange covering carter

## Technical details

- Polyester powder coating after a treatment specific for weathering resistance  
 - Hole and terminal block 4x16mm<sup>2</sup> CLII with fuse holder and inspection door  
 - A2 stainless steel screws

## Compulsory accessory (to be ordered separately)

- Counter flange 250x250x3mm and anchor bolts kit M16x500mm (only system B)

## Buried pole - System A

Total height	Total ground height	Anthracite RAL 7016 textured	
4500mm	4000mm	3038.100S	1

## Flanged pole - System B

4000mm	4000mm	3039.100S	1
--------	--------	-----------	---

## Compulsory accessory system B

	Code	
Counter flange and anchor bolts kit	4000.0003	1



 **Suggested plinth**  
 800x800x800mm  
 Pole conforming to DIN norms

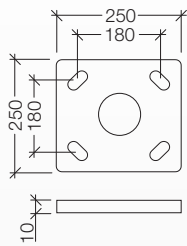

Flange for floor installation  
 Fixing holes Ø18mm

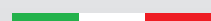
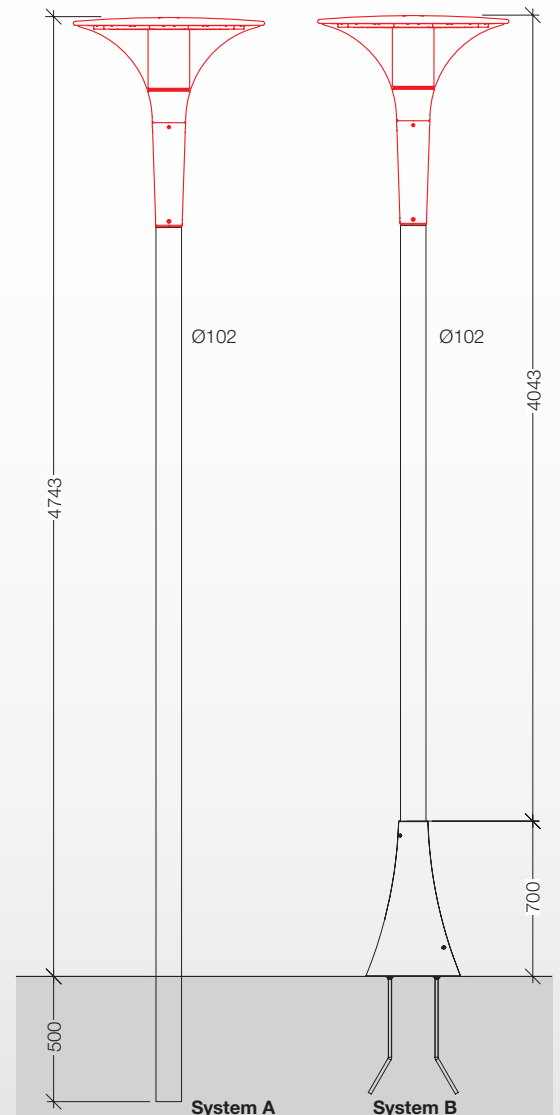
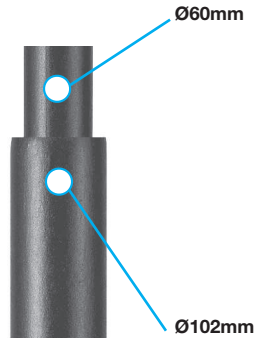

# Stud Solar System

## Buried pole - System A

- Cylindrical pole  $\varnothing 102/60 \times 3500$ mm for ground fixing made of hot-dip galvanised steel  $75\mu\text{m}$  UNI EN 1461

## Flanged pole - System B

- Cylindrical pole  $\varnothing 102/60 \times 3000$ mm for plinth/floor fixing complete with flange made of hot-dip galvanised steel  $75\mu\text{m}$  UNI EN 1461  
 - 250x250mm flange, 10mm thick made of hot-dip galvanised steel  $75\mu\text{m}$  UNI EN 1461  
 - Painted thermoplastic flange covering carter

## Technical details

- Polyester powder coating after a treatment specific for weathering resistance  
 - A2 stainless steel screws

## Compulsory accessory (to be ordered separately)

- Counter flange 250x250x3mm and anchor bolts kit M16x500mm (only system B)

## Buried pole - System A

Total height	Total ground height	Anthracite RAL 7016 textured	
3500mm	3000mm	1880.100M	1

## Flanged pole - System B

3000mm	3000mm	1881.100M	1
--------	--------	-----------	---

## Compulsory accessory system B

	Code	
Counter flange and anchor bolts kit	4000.0003	1



**Suggested plinth**  
 800x800x800mm  
 Pole conforming to DIN norms

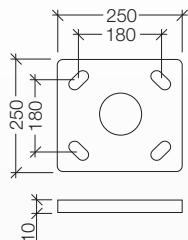

Flange for floor installation  
 Fixing holes  $\varnothing 18$ mm

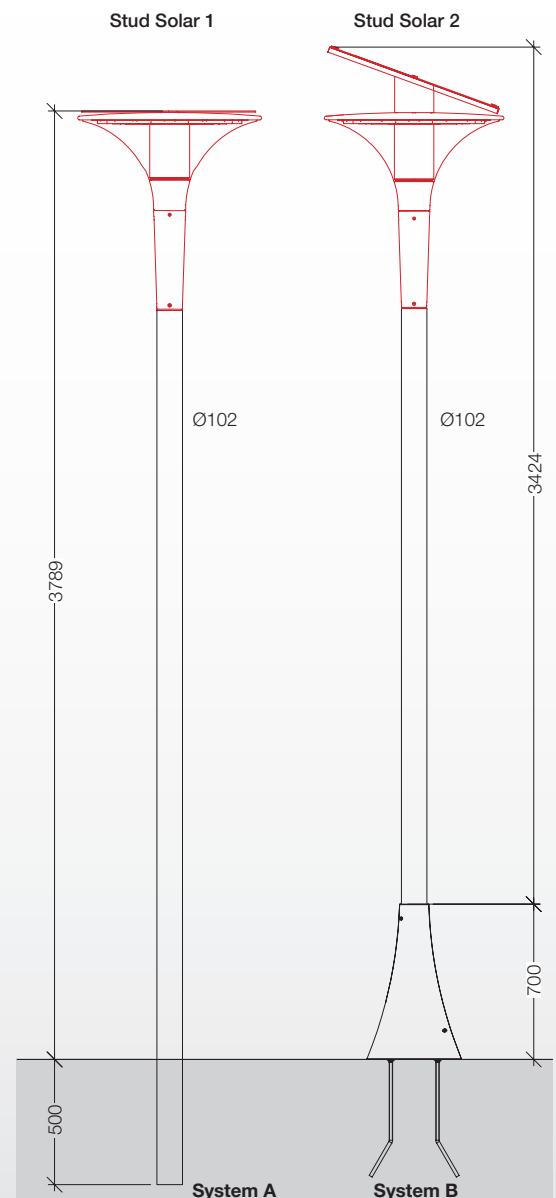
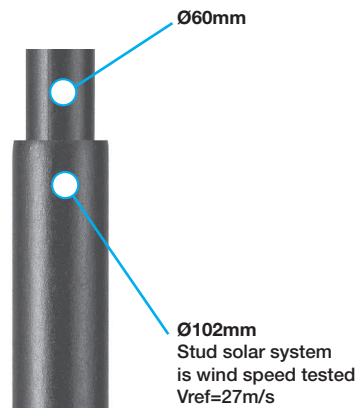
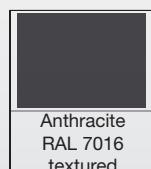

POLES AND SYSTEMS

Luminaire/Poles									
	Full Black	Full Color	Rigo	Toce	Piave	Stud System	Stud Solar System	Oracolo Wall System	New Stelo TP Wall System
Edge Head-pole	--	--	--	--	✓	--	--	--	--
Challenge Basic Head-pole	--	--	--	--	✓	--	--	--	--
Discovery Head-pole	--	--	--	--	✓	--	--	--	--
Discovery Side entry	--	--	--	--	✓	--	--	--	--
Cd Led	--	--	--	✓	✓	--	--	--	--
Stud Led	--	--	--	--	--	✓	--	--	--
Stud Solar	--	--	--	--	--	--	✓	--	--
Oracolo	--	--	--	--	✓	--	--	✓	--
Indus	--	--	--	--	✓	--	--	--	--
Skill	--	--	--	--	✓	--	--	--	--
Barcellona & Barrio Range	--	--	--	✓	✓	--	--	--	--
Easy Lux TP	✓	--	✓	--	--	--	--	--	--
Coled TP	✓	✓	--	--	--	--	--	--	--
New Stelo TP Range	✓	--	✓	--	--	--	--	--	✓
Antera	✓	✓	--	--	--	--	--	--	--
Versus	✓	✓	✓	--	--	--	--	--	--
Luna	--	✓	--	--	--	--	--	--	--
Luna TP	✓	✓	✓	--	--	--	--	--	--
Chone Solar	✓	✓	✓	--	--	--	--	--	--
Sfera Led Ø250/300	✓	--	✓	--	--	--	--	--	--
Sfera Led Ø400	--	--	--	✓	--	--	--	--	--
Sfera Led Ø500	--	--	--	✓	--	--	--	--	--
Sfera 1080	✓	--	✓	--	--	--	--	--	--
Sfera Ø400	--	--	--	✓	--	--	--	--	--
Sfera Ø500	--	--	--	✓	--	--	--	--	--
Sfera Ø600	--	--	--	✓	--	--	--	--	--

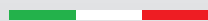

# Technical details